

Wurzelstift-Aufbausysteme Root Post Restoration Systems Systèmes de restauration radiculaire

HeadMaster konischer Kopf, passiv

7.16, 7.17



HeadMaster tapered head, passive

HeadMaster tête conique, passif

HeadMaster konischer Kopf, aktiv

7.18, 7.19



HeadMaster tapered head, active

HeadMaster tête conique, actif

HeadMaster zylindrischer Kopf, passiv

7.20, 7.21



HeadMaster cylindrical head, passive

HeadMaster tête cylindrique, passif

HeadMaster zylindrischer Kopf, aktiv

7.22, 7.23



HeadMaster cylindrical head, active

HeadMaster tête cylindrique, actif

PinMaster, aktiv

7.24



PinMaster, active

PinMaster, actif

PostMaster, passiv

7.25



PostMaster, passive

PostMaster, passif

Wurzelstift-Aufbausysteme

Root Post Restoration Systems

Systèmes de restauration radiculaire

Praxis • Dental Surgery • Cabinet dentaire

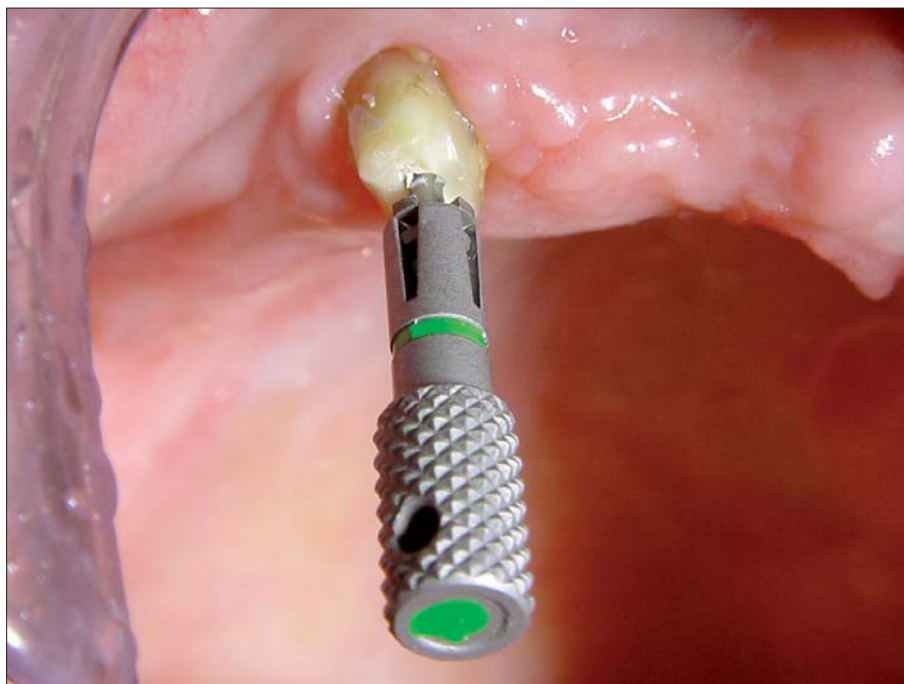

HeadMaster konischer Kopf, passiv • HeadMaster tapered head, passive • HeadMaster tête conique, passif

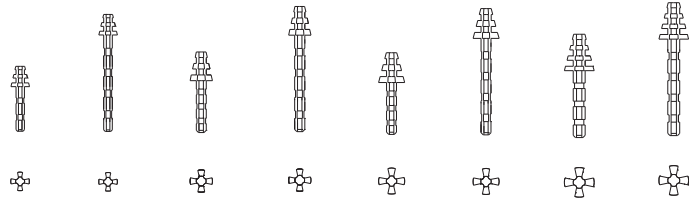
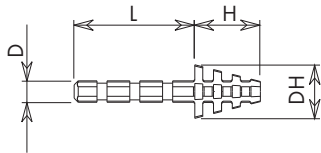

TITAN • TITANIUM (Ti6Al4V)

Farbkodierung/Größe * Colour Code/Size * Code couleur /taille		1		2		3		4	
Stiftschaft ø • Post Shank dia. • Tige ø	D mm	1.15		1.35		1.35		1.6	
Stiftschaftlänge • L. of Post Shank • Longueur	L mm	6	13	7	13	7	13	9	13
Kopf ø • Head dia. • Tête ø	DH mm	2.5	2.5	3	3	3.5	3.5	4	4
Kopfhöhe • Head Length • Longueur de la tête	H mm	2.75	2.75	3.85	3.85	4.0	4.0	4.9	4.9

10 Titan Gewindestift, 1 Peeso, 1 Vorbohrer, 1 Planfräser, 1 Steckschlüssel • 10 Titanium Posts, 1 Peeso, 1 Drill, 1 Root Facer, 1 Socket Wrench • 10 Tenons en titane, 1 Peeso, 1 foret, 1 fraise à surfacier, 1 clé pour ancrage



REF Sortiment • Assortment • Assortiment	W6302	W6303	W6304	W6305	W6306	W6307	W6308	W6309
--	--------------	--------------	--------------	--------------	--------------	--------------	--------------	--------------

10 Titan Gewindestifte, 10 Titanium Posts, 10 Tenons en titane

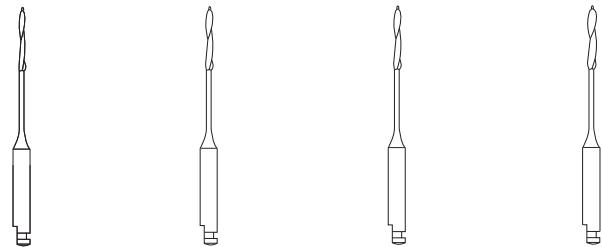
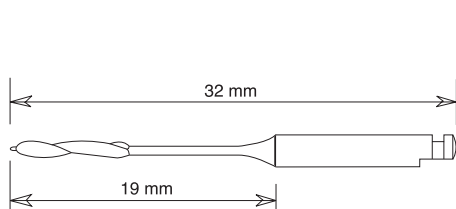
REF Nachfüllpackung • Refill • Recharge	W6310	W6311	W6312	W6313	W6314	W6315	W6316	W6317
---	--------------	--------------	--------------	--------------	--------------	--------------	--------------	--------------



Peeso

Schaftkodierung/Ringe* Shank marks/rings* Codification de tiges/bagues		2		3		3		4	
ISO 330 204 682 336 ...	 REF 183.15. ...	090		110		110		130	
ISO 330 205 682 336 ...	 REF 183.19. ...	090		110		110		130	

opt. 800 - 1.000 rpm

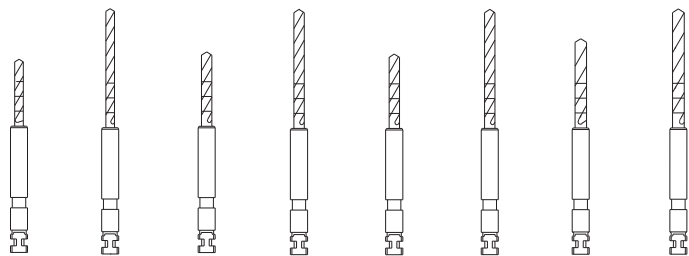
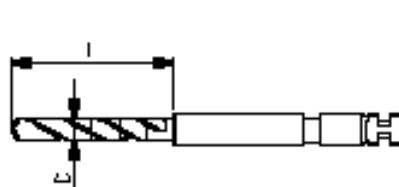

Vorbohrer • Drill • Foret

Farbkodierung/Größe * Colour Code/Size * Code couleur /taille		1		2		3		4	
Bohrer ø • Drill dia. • Foret ø	D mm	1.2		1.4		1.4		1.65	
Bohrerlänge • Length of Drill • L. à foret	L mm	9	16	10	16	10	16	12	16

 REF	W6320	W6321	W6322	W6323	W6324	W6325	W6326	W6327
---	--------------	--------------	--------------	--------------	--------------	--------------	--------------	--------------

opt. 500 - 1.000 rpm

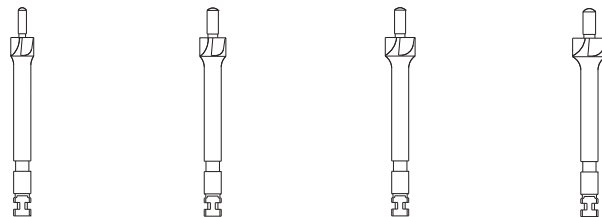
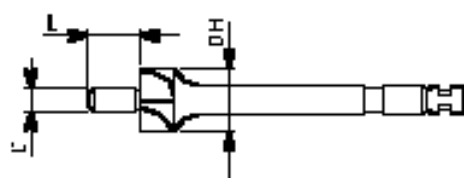

Planfräser • Root Facer • Fraise à surfacier

Farbkodierung/Größe * Colour Code/Size * Code couleur /taille		1		2		3		4	
Zapfen ø • Guide Pin dia. • Pivot ø	D mm	1.1		1.3		1.3		1.55	
Zapfenl. • Length of Pin • Longueur du pivot	L mm	4.0		4.0		4.0		4.0	
Kopf ø • Head dia. • Tête ø	DH mm	3.0		3.5		4.0		4.5	

 REF	W6330	W6331	W6332	W6333
---	--------------	--------------	--------------	--------------

opt. 1000 - 1.500 rpm

HeadMaster konischer Kopf, passiv • HeadMaster tapered head, passive • HeadMaster tête conique, passif

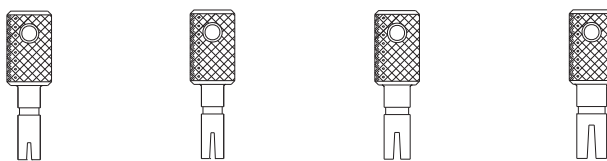
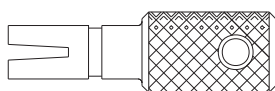

Steckschlüssel • Socket Wrench • Clé pour ancrage

Farbkodierung/Größe * Colour Code/Size * Code couleur /taille

1	2	3	4
W6350	W6351	W6352	W6353



REF W6300 Inhalt/Contents/Contenu: W6302, W6304, W6306, W6308 • Sortiment groß/ Economy Assortment/ Grand assortiment



REF W6301 Inhalt/Contents/Contenu: W6303, W6305, W6307, W6309 • Sortiment groß/ Economy Assortment/ Grand assortiment



HeadMaster konischer Kopf, aktiv • HeadMaster tapered head, active • HeadMaster tête conique, actif

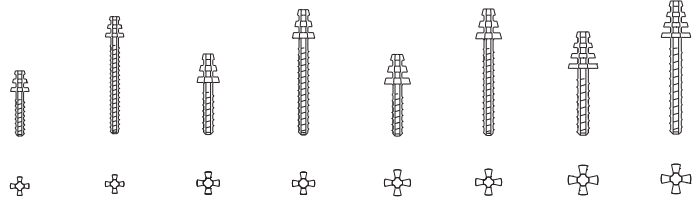
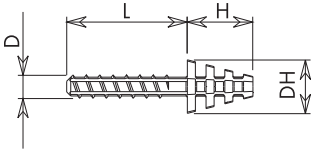

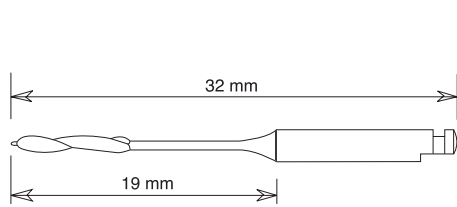

TITAN • TITANIUM (Ti6Al4V)

Farbkodierung/Größe * Colour Code/Size * Code couleur /taille		1	2	3	4				
Stiftschaft ø • Post Shank dia. • Tige ø	D mm	1.3	1.5	1.5	1.75				
Stiftschäftl. • L. of Post Shank • Longueur	L mm	6 13	7 13	7 13	9 13				
Kopf ø • Head dia. • Tête ø	DH mm	2.5 2.5	3 3	3.5 3.5	4 4				
Kopfhöhe • Head Length • Longueur de la tête	H mm	2.75 2.75	3.85 3.85	4.0 4.0	4.9 4.9				
10 Titan Gewindestift, 1 Peeso, 1 Vorbohrer, 1 Planfräser, 1 Steckschlüssel • 10 Titanium Posts, 1 Peeso, 1 Drill, 1 Root Facer, 1 Socket Wrench • 10 Tenons en titane, 1 Peeso, 1 foret, 1 Fraise à surfacer, 1 clé pour ancrage									
REF Sortiment • Assortment • Assortiment		W6202	W6203	W6204	W6205	W6206	W6207	W6208	W6209
10 Titan Gewindestifte, 10 Titanium Posts, 10 Tenons en titane									
REF Nachfüllpackung • Refill • Recharge		W6210	W6211	W6212	W6213	W6214	W6215	W6216	W6217



Peeso

Schaftkodierung/Ringe * Shank marks/rings * Codification de tiges/bagues	2	3	3	4			
ISO 330 204 682 336 ...  REF 183.15. ...	090	110	110	130			
ISO 330 205 682 336 ...  REF 183.19. ...		090	110	110	110	130	130
opt. 800 - 1.200 rpm							

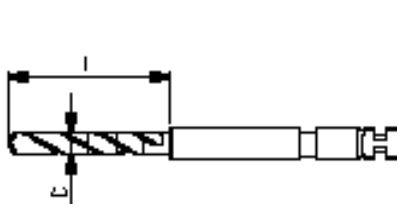
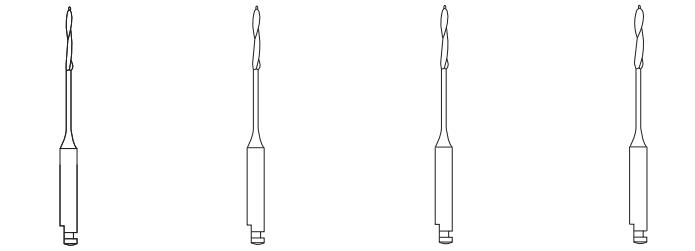

Vorbohrer • Drill • Foret

Farbkodierung/Größe * Colour Code/Size * Code couleur /taille		1	2	3	4				
Bohrer ø • Drill dia. • Foret ø	D mm	1.2	1.4	1.4	1.65				
Bohrerlänge • Length of Drill • L. à foret	L mm	9 16	10 16	10 16	12 16				
 REF		W6320	W6321	W6322	W6323	W6324	W6325	W6326	W6327
opt. 500 - 1.000 rpm									

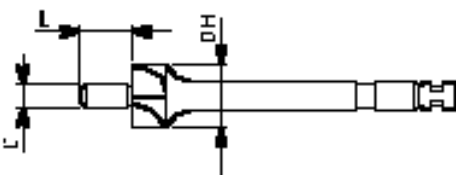
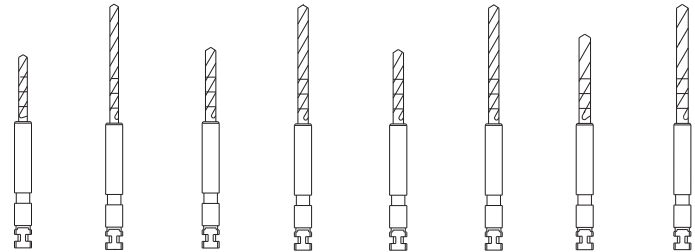

Planfräser • Root Facer • Fraise à surfacer

Farbkodierung/Größe * Colour Code/Size * Code couleur /taille		1	2	3	4
Zapfen ø • Guide Pin dia. • Pivot ø	D mm	1.1	1.3	1.3	1.55
Zapfenl. • Length of Pin • Longueur du pivot	L mm	4.0	4.0	4.0	4.0
Kopf ø • Head dia. • Tête ø	DH mm	3.0	3.5	4.0	4.5
 REF		W6330	W6331	W6332	W6333
opt. 1.000 - 1.500 rpm					

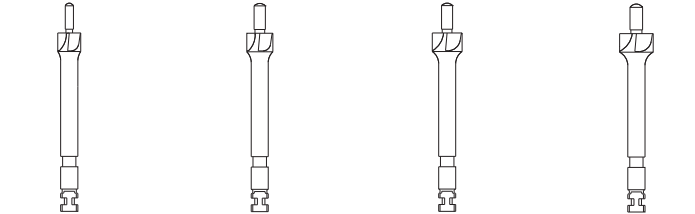

HeadMaster konischer Kopf, aktiv • HeadMaster tapered head, active • HeadMaster tête conique, actif

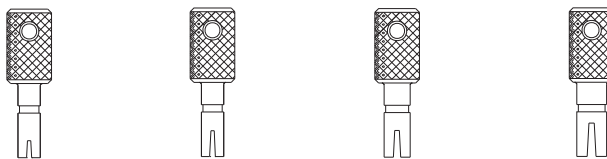
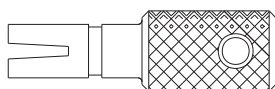

Steckschlüssel • Socket Wrench • Clé pour ancrage

Farbkodierung/Größe * Colour Code/Size * Code couleur /taille

1	2	3	4
W6350	W6351	W6352	W6353



REF W6200 Inhalt/Contents/Contenu: W6202, W6204, W6206, W6208 • Sortiment groß/ Economy Assortment/ Grand assortiment



REF W6201 Inhalt/Contents/Contenu: W6203, W6205, W6207, W6209 • Sortiment groß/ Economy Assortment/ Grand assortiment



HeadMaster zylindrischer Kopf, passiv • HeadMaster cylindrical head, passive • HeadMaster tête cylindrique, passiv

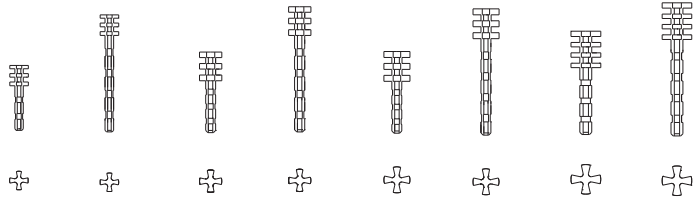
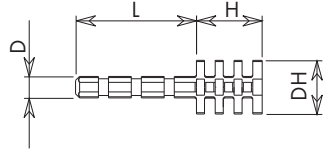

TITAN • TITANIUM (Ti6Al4V)

Farbkodierung/Größe * Colour Code/Size * Code couleur /taille		1		2		3		4	
Stiftschaft ø • Post Shank dia. • Tige ø	D mm	1.15		1.35		1.35		1.6	
Stiftschäftl. • L. of Post Shank • Longueur	L mm	6	13	7	13	7	13	9	13
Kopf ø • Head dia. • Tête ø	DH mm	2.5	2.5	3	3	3.5	3.5	4	4
Kopfhöhe • Head Length • Longueur de la tête	H mm	2.75	2.75	3.85	3.85	4.0	4.0	4.9	4.9

10 Titan Gewindestift, 1 Peeso, 1 Vorbohrer, 1 Planfräser, 1 Steckschlüssel • 10 Titanium Posts, 1 Peeso, 1 Drill, 1 Root Facer, 1 Socket Wrench • 10 Tenons en titane, 1 Peeso, 1 foret, 1 Fraise à surfer, 1 clé pour ancrage



REF Sortiment • Assortiment • Assortiment	W6502	W6503	W6504	W6505	W6506	W6507	W6508	W6509
---	-------	-------	-------	-------	-------	-------	-------	-------

10 Titan Gewindestifte, 10 Titanium Posts, 10 Tenons en titane

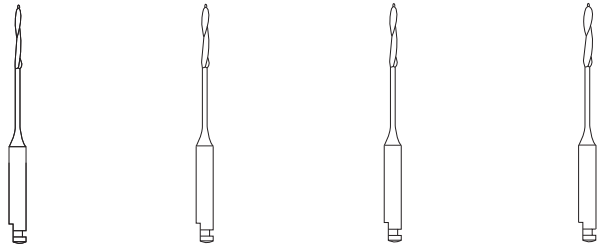
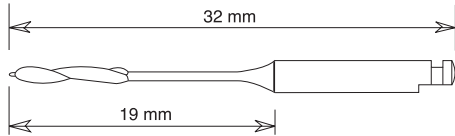
REF Nachfüllpackung • Refill • Recharge	W6510	W6511	W6512	W6513	W6514	W6515	W6516	W6517
---	-------	-------	-------	-------	-------	-------	-------	-------



Peeso

Schafkkodierung/Ringe * Shank marks/rings * Codification de tiges/bagues		2		3		3		4	
ISO 330 204 682 336 ...	 REF 183.15. ...	090		110		110		130	
ISO 330 205 682 336 ...	 REF 183.19. ...		090		110		110		130

max. 800 - 1.200 rpm

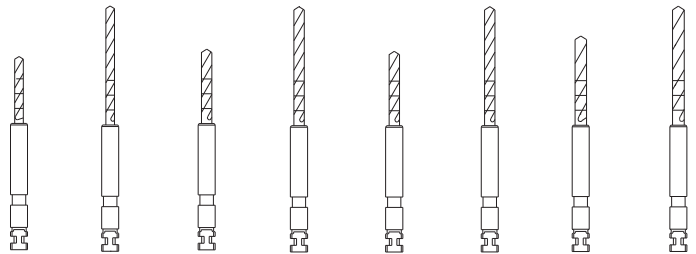
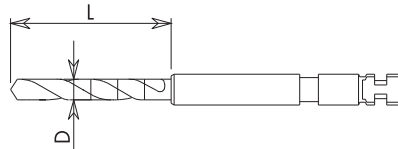

Vorbohrer • Drill • Foret

Farbkodierung/Größe * Colour Code/Size * Code couleur /taille		1		2		3		4	
Bohrer ø • Drill dia. • Foret ø	D mm	1.2		1.4		1.4		1.65	
Bohrerlänge • Length of Drill • L. du foret	L mm	9	16	10	16	10	16	12	16

 REF	W6320	W6321	W6322	W6323	W6324	W6325	W6326	W6327
---	-------	-------	-------	-------	-------	-------	-------	-------

opt. 500 - 1.000 rpm

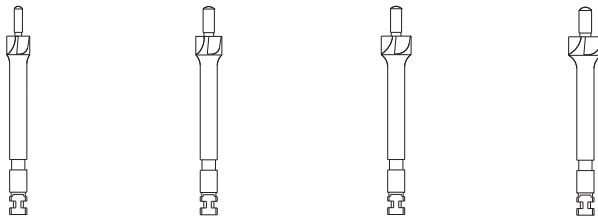
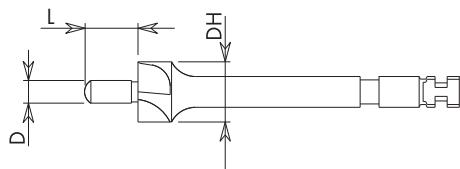

Planfräser • Root Facer • Fraise à surfer

Farbkodierung/Größe * Colour Code/Size * Code couleur /taille		1		2		3		4	
Zapfen ø • Guide Pin dia. • Pivot ø	D mm	1.1		1.3		1.3		1.55	
Zapfenl. • Length of Pin • Longueur du pivot	L mm	4.0		4.0		4.0		4.0	
Kopf ø • Head dia. • Tête ø	DH mm	3.0		3.5		4.0		4.5	

 REF	W6330	W6331	W6332	W6333
---	-------	-------	-------	-------

opt. 1.000 - 1.500 rpm

HeadMaster zylindrischer Kopf, passiv • HeadMaster cylindrical head, passive • HeadMaster tête cylindrique, passif

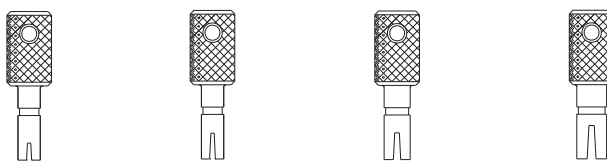
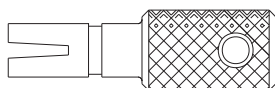

Steckschlüssel • Socket Wrench • Clé pour ancrage

Farbkodierung/Größe * Colour Code/Size * Code couleur /taille

1	2	3	4
---	---	---	---



W6450

W6451

W6452

W6453

Praxis • Dental Surgery • Cabinet dentaire

REF W6500 Inhalt/Contents/Contenu: W6502, W6504, W6506, W6508 • Sortiment groß/ Economy Assortment/ Grand assortiment



W6501 Inhalt/Contents/Contenu: W6503, W6505, W6507, W6509 • Sortiment groß/ Economy Assortment/ Grand assortiment



HeadMaster zylindrischer Kopf, aktiv • HeadMaster cylindrical head, active • HeadMaster tête cylindrique, actif

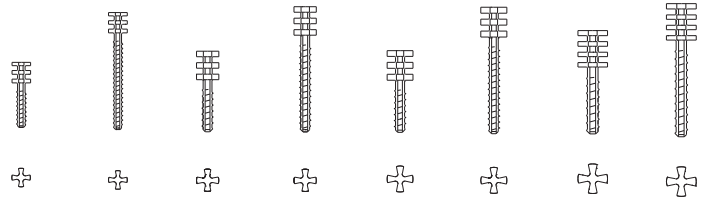
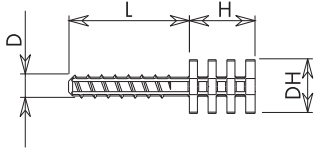

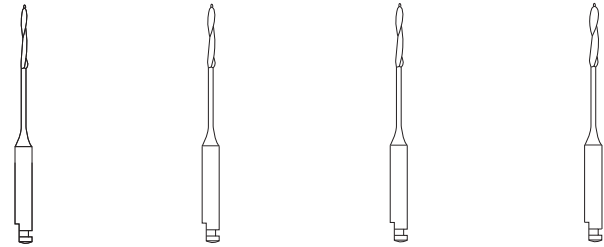
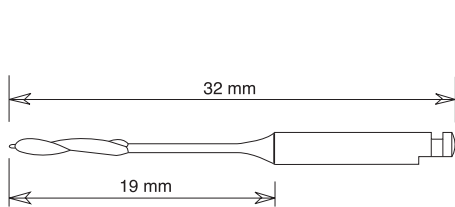

TITAN • TITANIUM (Ti6Al4V)

Farbkodierung/Größe * Colour Code/Size * Code couleur /taille		1	2	3	4				
Stiftschafst. • Post Shank dia. • Tige ø	D mm	1.3	1.5	1.5	1.75				
Stiftschafst. • L. of Post Shank • Longueur	L mm	6 13	7 13	7 13	9 13				
Kopf ø • Head dia. • Tête ø	DH mm	2.5 2.5	3 3	3.5 3.5	4 4				
Kopfhöhe • Head Length • Longueur de la tête	H mm	2.75 2.75	3.85 3.85	4.0 4.0	4.9 4.9				
10 Titan Gewindestift, 1 Peeso, 1 Vorbohrer, 1 Planfräser, 1 Steckschlüssel • 10 Titanium Posts, 1 Peeso, 1 Drill, 1 Root Facer, 1 Socket Wrench • 10 Tenons en titane, 1 Peeso, 1 foret, 1 fraise à surfer, 1 clé pour ancrage									
REF Sortiment • Assortment • Assortiment		W6402	W6403	W6404	W6405	W6406	W6407	W6408	W6409
10 Titan Gewindestifte, 10 Titanium Posts, 10 Tenons en titane									
REF Nachfüllpackung • Refill • Recharge		W6410	W6411	W6412	W6413	W6414	W6415	W6416	W6417



Peeso

Schaftkodierung/Ringe * Shank marks/rings * Codification de tiges/bagues	2	3	3	4			
ISO 330 204 682 336 ...  REF 183.15. ...	090	110	110	130			
ISO 330 205 682 336 ...  REF 183.19. ...		090	110	110	110	130	130

opt. 800 - 1.200 rpm

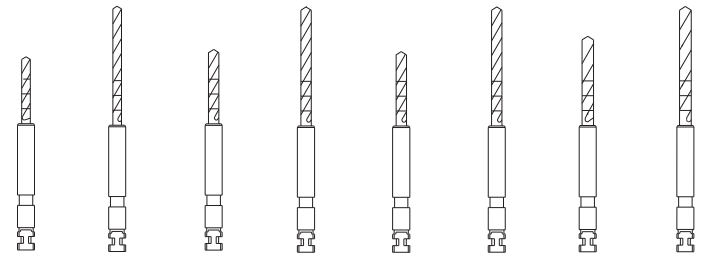
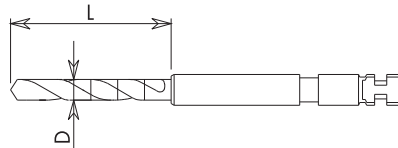

Vorbohrer • Drill • Foret

Farbkodierung/Größe * Colour Code/Size * Code couleur /taille		1	2	3	4				
Bohrer ø • Drill dia. • Foret ø	D mm	1.2	1.4	1.4	1.65				
Bohrerlänge • Length of Drill • L. du foret	L mm	9 16	10 16	10 16	12 16				
 REF		W6320	W6321	W6322	W6323	W6324	W6325	W6326	W6327

opt. 500 - 1.000 rpm

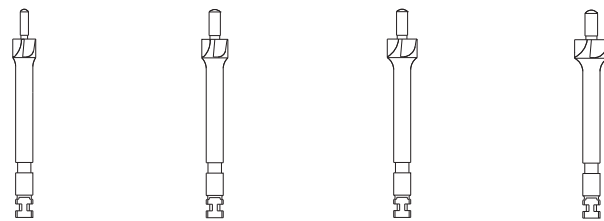
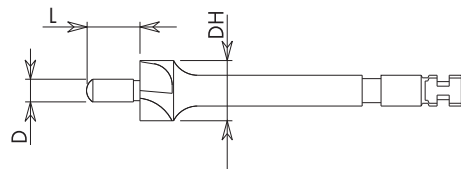

Planfräser • Root Facer • Fraise à surfer

Farbkodierung/Größe * Colour Code/Size * Code couleur /taille		1	2	3	4
Zapfen ø • Guide Pin dia. • Pivot ø	D mm	1.1	1.3	1.3	1.55
Zapfenl. • Length of Pin • Longueur du pivot	L mm	4.0	4.0	4.0	4.0
Kopf ø • Head dia. • Tête ø	DH mm	3.0	3.5	4.0	4.5
 REF		W6330	W6331	W6332	W6333

opt. 1.000 - 1.500 rpm

HeadMaster zylindrischer Kopf, aktiv • HeadMaster cylindrical head, active • HeadMaster tête cylindrique, actif

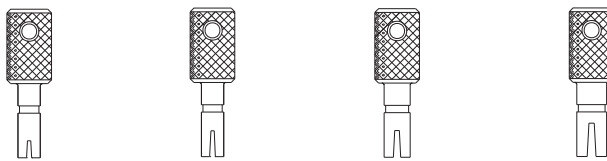
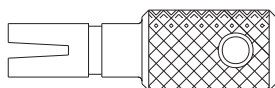

Steckschlüssel • Socket Wrench • Clé pour ancrage

Farbkodierung/Größe * Colour Code/Size * Code couleur /taille

1	2	3	4
W6450	W6451	W6452	W6453



W6400 Inhalt/Contents/Contenu: W6402, W6404, W6406, W6408 • Sortiment groß/ Economy Assortment/ Grand assortiment



W6401 Inhalt/Contents/Contenu: W6403, W6405, W6407, W6409 • Sortiment groß/ Economy Assortment/ Grand assortiment



PinMaster, aktiv • PinMaster, active • PinMaster, actif

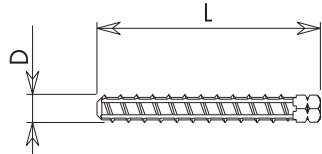

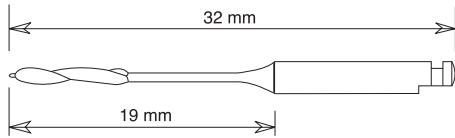

TITAN • TITANIUM (Ti6Al4V)

Farbkodierung/Größe * Colour Code/Size * Code couleur /taille		1	2	3
Stiftschaft ø • Post Shank dia. • Tige ø	D mm	1.3	1.5	1.75
Stiftschaftl. • L. of Post Shank • Longueur	L mm	8.75 16.5	10.85 16.5	13.9 16.5
10 Titan Gewindestift, 1 Peeso, 1 Vorbohrer, 1 Steckschlüssel • 10 Titanium Posts, 1 Peeso, 1 Drill, 1 Socket Wrench • 10 Tenons en titane, 1 Peeso, 1 foret, 1 clé pour ancrage				
REF Sortiment • Assortment • Assortiment		W6102	W6103	W6104 W6105 W6106 W6107
10 Titan Gewindestifte, 10 Titanium Posts, 10 Tenons en titane				
REF Nachfüllpackung • Refill • Recharge		W6110	W6111 W6112 W6113 W6114 W6115	



Peeso

Schaftkodierung/Ringe * Shank marks/rings * Codification de tiges/bagues	2	3	4
ISO 330 204 682 336 ...  REF	183.15. ...	090	110 130
ISO 330 205 682 336 ...  REF	183.19. ...	090	110 130
opt. 800 - 1.200 rpm			

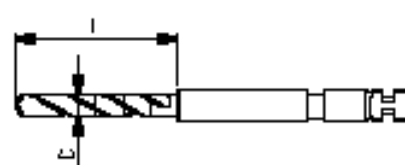

Vorbohrer • Drill • Foret

Farbkodierung/Größe * Colour Code/Size * Code couleur /taille		1	2	3
Bohrer ø • Drill dia. • Foret ø	D mm	1.2	1.4	1.65
Bohrerlänge • Length of Drill • L. à foret	L mm	9 16	10 16	12 16
 REF		W6320 W6321 W6322 W6323 W6326 W6327		
opt. 500 - 1.000 rpm				

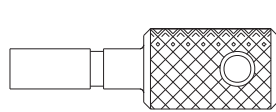

Steckschlüssel • Socket Wrench

Farbkodierung/Größe * Colour Code/Size * Code couleur /taille		1	2	3
 REF		W6150	W6151	W6152



REF **W6101**
Inhalt/Contents/Contenu:
W6103, W6105, W6107
lange Stifte, long posts,
Tenons longue

W6100
Inhalt/Contents/Contenu:
W6102, W6104, W6106
kurze Stifte, short posts,
Tenons courte

PostMaster, passiv • PostMaster, passive • PostMaster, passif

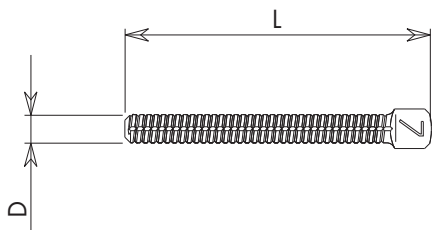

TITAN • TITANIUM (Ti6Al4V)

Farbkodierung/Größe * Colour Code/Size * Code couleur /taille		3	4	5	6	7
Stiftschaft ø • Post Shank dia. • Tige ø	D mm	0.9	1.0	1.25	1.5	1.75
Stiftschafil. • L. of Post Shank • Longueur	L mm	19	19	19	19	19
10 Titan Gewindestift, 1 Peeso, 1 Vorbohrer • 10 Titanium Posts, 1 Peeso, 1 Drill • 10 Tenons en titane, 1 Peeso, 1 foret						
REF Sortiment • Assortment • Assortiment		W6002	W6003	W6004	W6005	W6006
10 Titan Gewindestift, 1 Peeso, 1 Vorbohrer lang • 10 Titanium Posts, 1 Peeso, 1 Drill long • 10 Tenons en titane, 1 Peeso, 1 foret long						
REF Sortiment • Assortment • Assortiment		W6002L	W6003L	W6004L	W6005L	W6006L
10 Titan Gewindestifte, 10 Titanium Posts, 10 Tenons en titane						
REF Nachfüllpackung • Refill • Recharge		W6010	W6011	W6012	W6013	W6014

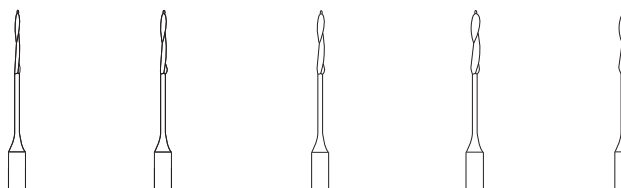
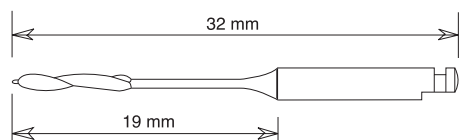

Peeso

Schaftkodierung/Ringe * Shank marks/rings * Codification de tiges/bagues	1	2	3	4	5
ISO 330 205 682 336 ...  REF 183.19. ...	070	090	110	130	150

opt. 800 - 1.200 rpm

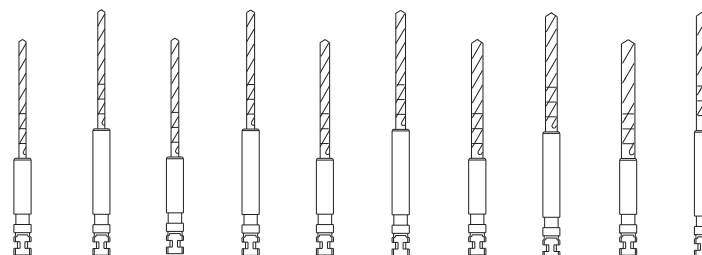
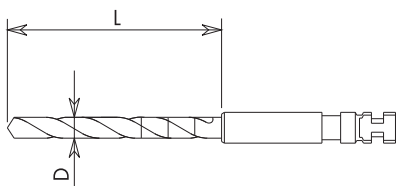

Vorbohrer • Drill • Foret

Farbkodierung/Größe * Colour Code/Size * Code couleur /taille		3	4	5	6	7					
Bohrer ø • Drill dia. • Foret ø	D mm	0.95	1.05	1.30	1.55	1.80					
Bohrerlänge • Length of Drill • L. du foret	L mm	16	16	16	16	16					
REF		W6020	W6021	W6022	W6023	W6024	W6025	W6026	W6027	W6028	W6029

opt. 500 - 1.000 rpm